



Huge-solar

Sparkle Series

M182H654-410-445W

410-445W Mono

High power, high efficiency and low BOS & LCOE, Topcon cell technology, combines nondestructive cutting 182mm large-size silicon wafer, and gapless ribbon connection technology, the modules can offer higher output with improved module efficiency. Half Cell design ensures less shading effect and lower resistive loss, lower risk of hot spot, as well as more reliable and stable power generation.

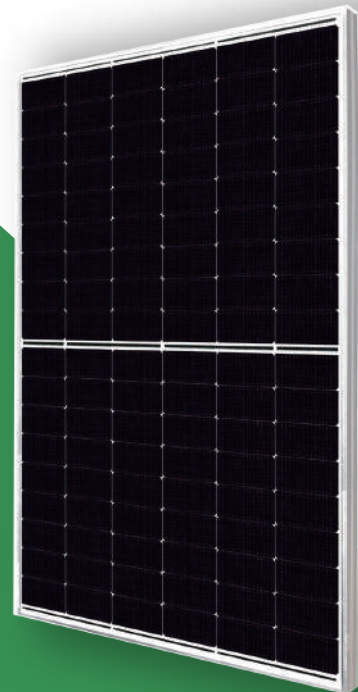

Linear performance Warranty

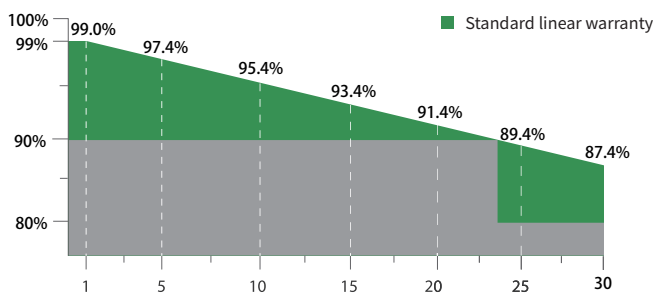

Linear performance warranty



Product warranty

Comprehensive Certificates

CERTIFICATION

- IEC61215/IEC61730
- ISO9001:Quality Management System
- ISO14001:Environmental Management System
- ISO45001:Occupational Health and Safety Management System



QIDONG SHENYA INDUSTRY CO., LTD

TEL: +86 15250188350 E-mail: paul@huge-solar.com
ADD: No.249 GongYuan Road, Qidong Jiangsu China

| Electrical Specificatio | | | | | | | | | | | | | | | | | |
|-----------------------------|----------------------|---------------|-------|---------------|-------|---------------|-------|---------------|-------|---------------|-------|---------------|-------|---------------|-------|---------------|-------|
| Module Type | | M182H654-410W | | M182H654-415W | | M182H654-420W | | M182H654-425W | | M182H654-430W | | M182H654-435W | | M182H654-440W | | M182H654-445W | |
| Test Standards | | STC | NOCT | STC | NOCT | STC | NOCT | STC | NOCT | STC | NOCT | STC | NOCT | STC | NOCT | STC | NOCT |
| Maximum Power | P _{max} (W) | 410 | 311 | 415 | 315 | 420 | 318 | 425 | 322 | 430 | 326 | 435 | 330 | 440 | 334 | 445 | 338 |
| Maximum Power Voltage | V _{mp} (V) | 31.5 | 29.6 | 31.7 | 29.8 | 31.9 | 30.0 | 32.1 | 30.2 | 32.3 | 30.3 | 32.5 | 30.5 | 32.7 | 30.7 | 32.9 | 30.9 |
| Maximum Power Current | I _{mp} (A) | 13.05 | 10.52 | 13.11 | 10.57 | 13.17 | 10.62 | 13.24 | 10.67 | 13.32 | 10.74 | 13.39 | 10.82 | 13.46 | 10.88 | 13.53 | 10.94 |
| Open Circuit Voltage | V _{oc} (V) | 37.5 | 35.8 | 37.7 | 36.0 | 37.9 | 36.2 | 38.1 | 36.4 | 38.3 | 36.6 | 38.4 | 36.8 | 38.6 | 37.0 | 38.8 | 37.2 |
| Short Circuit Current | I _{sc} (A) | 13.85 | 11.15 | 13.92 | 11.21 | 13.98 | 11.27 | 14.05 | 11.33 | 14.12 | 11.38 | 14.18 | 11.44 | 14.25 | 11.49 | 14.32 | 11.54 |
| Module Efficiency | (%) | 20.97 | | 21.23 | | 21.48 | | 21.74 | | 21.99 | | 22.25 | | 22.51 | | 22.76 | |
| Power Output Tolerance | (W) | 0±5 | | | | | | | | | | | | | | | |
| Tolerance During Power Test | (%) | ±3 | | | | | | | | | | | | | | | |

*(STC)*irradiance 1000W/m², Module Temperature 25 C, Air Mass 1.5
 *(NOCT)*irradiance 800W/m², Ambient Temperature 20 C, Wind Speed 1m/s

| Mechanical Data | |
|---|--|
| Number of Cells | 108Cells(6×18) |
| Dimensions of Module L*W*H (mm) | 1724×1134×30mm |
| Weight (kg) | 21kg |
| Glass | High transparency solar glass 3.2mm |
| Backsheet | white |
| Frame | anodized aluminium alloy |
| J-BOX | IP68, 3 diodes |
| Cable | 4.0mm ² , 900mm or customized |
| Wind/Snow Load | 2400Pa/5400Pa* |
| Connector | MC Compatible |
| *For more details please check the installation manual | |

| Temperature Ratings | |
|---|--------------------|
| Temperature Coefficient of P _{max} | -0.300%/C |
| Nominal Operating Cell Temperature(NOCT) | 44±2 C |
| Temperature Coefficient of I _{sc} | +0.045%/C |
| Temperature Coefficient of V _{oc} | -0.250%/C |
| Maximum Ratings | |
| Operational Temperature | -40 - +85 C |
| Maximum System Voltage | 1500V DC |
| Max Series Fuse Rating | 25A |
| Packaging Configuration | |
| Module per box | 36+36=72pieces |
| Module per 40'container | 936pieces(30Frame) |

ENGINEERING DRAWINGS

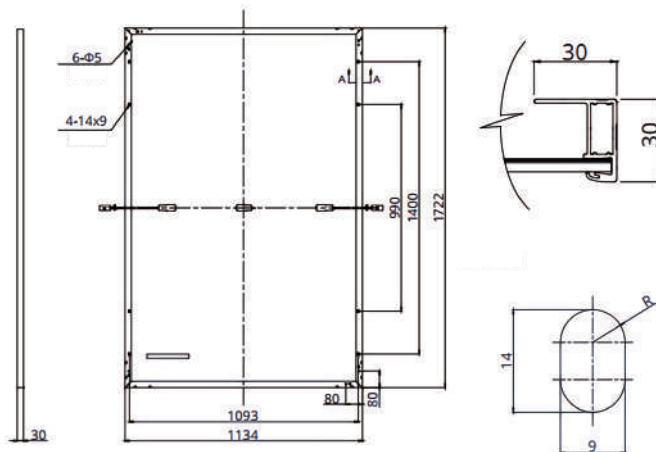

IV CURVES

