

410-445W Mono

Black frame, black backsheet, full black solar panel with 182mm Topcon monocrystalline silicon wafer, more elegant. High reliability, high-quality materials and advanced manufacturing processes ensure the consistently performance over time, even in harsh environmental conditions. The half-cell configuration makes less shading effect, lower risk of hot spot, as well as more reliable and stable power generation.

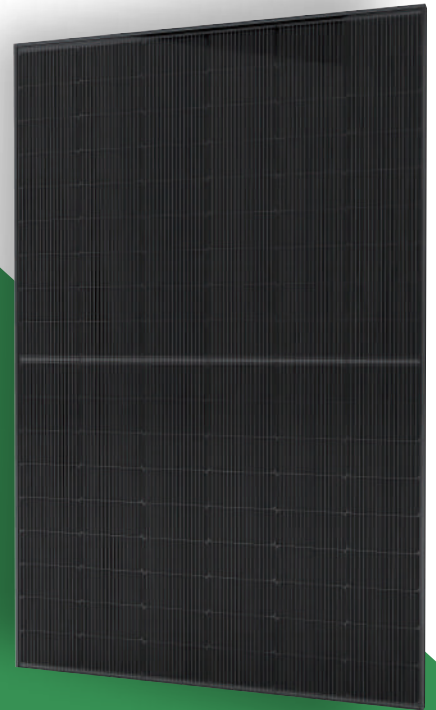

Linear performance Warranty

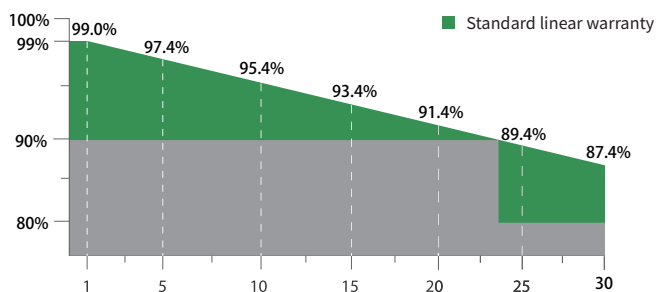

Linear performance warranty



Product warranty

Comprehensive Certificates

CERTIFICATION

- IEC61215/IEC61730
- ISO9001:Quality Management System
- ISO14001:Environmental Management System
- ISO45001:Occupational Health and Safety Management System



QIDONG SHENYA INDUSTRY CO., LTD

TEL: +86 15250188350 E-mail: paul@huge-solar.com
ADD: No.249 GongYuan Road, Qidong Jiangsu China

Electrical Specificatio																	
Module Type		M182H654-410W		M182H654-415W		M182H654-420W		M182H654-425W		M182H654-430W		M182H654-435W		M182H654-440W		M182H654-445W	
Test Standards		STC	NOCT	STC	NOCT	STC	NOCT	STC	NOCT	STC	NOCT	STC	NOCT	STC	NOCT	STC	NOCT
Maximum Power	P _{max} (W)	410	311	415	315	420	318	425	322	430	326	435	330	440	334	445	338
Maximum Power Voltage	V _{mp} (V)	31.5	29.6	31.7	29.8	31.9	30.0	32.1	30.2	32.3	30.3	32.5	30.5	32.7	30.7	32.9	30.9
Maximum Power Current	I _{mp} (A)	13.05	10.52	13.11	10.57	13.17	10.62	13.24	10.67	13.32	10.74	13.39	10.82	13.46	10.88	13.53	10.94
Open Circuit Voltage	V _{oc} (V)	37.5	35.8	37.7	36.0	37.9	36.2	38.1	36.4	38.3	36.6	38.4	36.8	38.6	37.0	38.8	37.2
Short Circuit Current	I _{sc} (A)	13.85	11.15	13.92	11.21	13.98	11.27	14.05	11.33	14.12	11.38	14.18	11.44	14.25	11.49	14.32	11.54
Module Efficiency	(%)	20.97		21.23		21.48		21.74		21.99		22.25		22.51		22.76	
Power Output Tolerance	(W)	0±5															
Tolerance During Power Test	(%)	±3															

*(STC)*irradiance 1000W/ m² , Module Temperature 25 C , Air Mass 1.5
 *(NOCT)*irradiance 800W/ m² , Ambient Temperature 20 C , Wind Speed 1m/s*

Mechanical Data	
Number of Cells	108Cells(6×18)
Dimensions of Module L*W*H (mm)	1724×1134×30mm
Weight (kg)	21kg
Glass	High transparency solar glass 3.2mm
Backsheet	black
Frame	anodized aluminium alloy
J-BOX	IP68, 3 diodes
Cable	4.0mm ² , 900mm or customized
Wind/Snow Load	2400Pa/5400Pa*
Connector	MC Compatible
*For more details please check the installation manual	

Temperature Ratings	
Temperature Coefficient of P _{max}	-0.300%/ C
Nominal Operating Cell Temperature(NOCT)	44±2 C
Temperature Coefficient of I _{sc}	+0.045%/ C
Temperature Coefficient of V _{oc}	-0.250%/ C
Maximum Ratings	
Operational Temperature	-40 - +85 C
Maximum System Voltage	1500V DC
Max Series Fuse Rating	25A
Packaging Configuration	
Module per box	36+36=72pieces
Module per 40'container	936pieces(30Frame)

ENGINEERING DRAWINGS

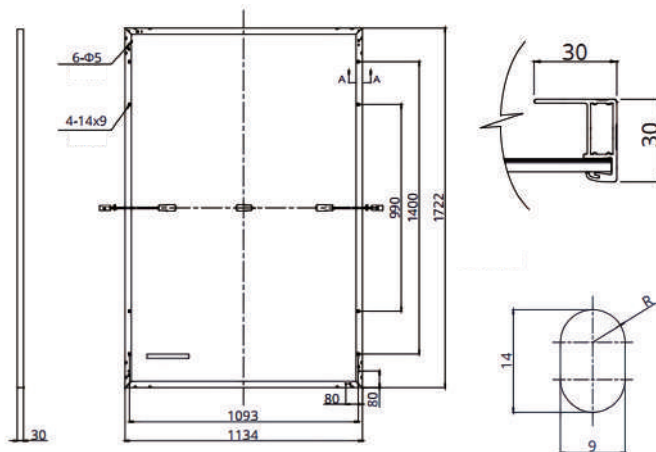

IV CURVES

